

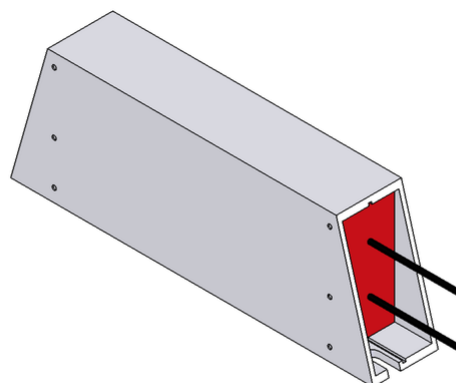

## DATA SHEET

### GWHS 60x30-K | 200 - 500 W Aluminium Resistor



| Article-No.   |          | ds3000 3114                   |            |            |            |
|---|----------|-------------------------------|------------|------------|------------|
| Type  |          | GWHS 167                      | GWHS 217   | GWHS 267   | GWHS 337   |
| Pulse Power (W) $T_a \sim 40^\circ\text{C}$<br>*referred to a<br>cycle duration of 120s<br>Approximate value (depending on<br>resistance) | ED 6 %*  | 1800                          | 2700       | 3600       | 4500       |
|   | ED 15 %* | 1000                          | 1500       | 2000       | 2500       |
|   | ED 25 %* | 600                           | 900        | 1200       | 1500       |
|   | ED 40 %* | 400                           | 600        | 800        | 1000       |
| Nominal continuous power (W) $T_a \sim 40^\circ\text{C}$  |          | 200                           | 300        | 400        | 500        |
| Resistance Values at $20^\circ\text{C}$ (Ohm)   |          | 2.5 - 910                     | 4.7 - 1000 | 6.2 - 1300 | 7.8 - 1800 |
| Tolerance of resistance at $20^\circ\text{C}$   |          | $\pm 10\%$                    |            |            |            |
| Degree of protection (EN 60529) (in the accordingly screwed on state)   |          | IP 54                         |            |            |            |
| Max. permissible operating voltage  |          | EN 1000 V DC                  |            |            |            |
| Cooling   |          | natural convection            |            |            |            |
| Housing temperature at nominal continuous power $T_a \sim 40^\circ\text{C}$   |          | ca. $360^\circ\text{C}$       |            |            |            |
| Electrical terminal   |          | 2x AWG 16 / l=25 cm           |            |            |            |
| Operation temperature range   |          | $-25 \dots +40^\circ\text{C}$ |            |            |            |
| Testing voltage   |          | 2.7 kV AC 1 s                 |            |            |            |
| Mounting positions  |          |                               |            |            |            |

Subject to technical modifications



## DATA SHEET

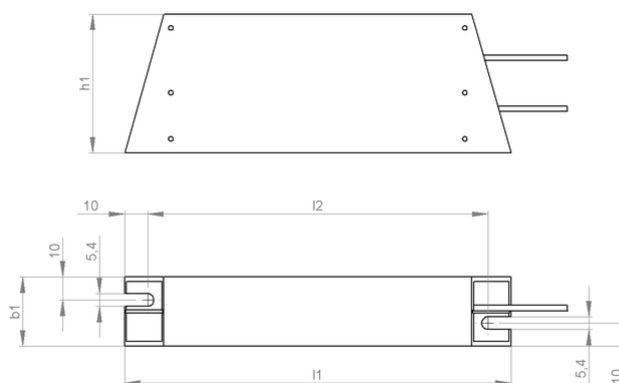

| Article-No.          |    | ds3000 3114 |          |          |          |
|----------------------|----|-------------|----------|----------|----------|
| Type                 |    | GWHS 167    | GWHS 217 | GWHS 267 | GWHS 337 |
| Length [mm]          | l1 | 167         | 217      | 267      | 337      |
|                      | l2 | 150         | 200      | 250      | 320      |
| Width [mm]           | b1 | 30          | 30       | 30       | 30       |
| Height [mm]          | h1 | 60          | 60       | 60       | 60       |
| Weight approx. [kg]  |    | 0.5         | 0.7      | 0.9      | 1.1      |
| Isolation resistance |    | >10 M Ohm   |          |          |          |
| Last update          |    | 2015-02-25  |          |          |          |

### Mounting instruction:

The distance between the two fixing points increase at 0,85 mm / 100 mm while heating (mounting with fixed and movable bearing).

The resistor should be protected by appropriate safety measures against overloading.

Do not mount the resistor with any obstruction in the air inlet or air outlet area.

Mount the resistor on a plane area.

The resistor has to be grounded.